

- NOTES:
- DO NOT SCALE. USE FIGURED DIMENSIONS ONLY.
 - THIS DRAWING IS TO BE READ IN CONJUNCTION WITH ALL OTHER RELEVANT ARCHITECTURAL AND ENGINEERING DRAWINGS.

LEGEND ROADS

- PROPOSED 125mm KERB
- SHARED SURFACE
- CENTER LINE WITH CHAINAGE
- RETAINING WALL / SLOPE STABILISATION
- FINISHED ROAD LEVELS
- ROAD GRADIENT
- PROPOSED GULLY
- RAMP

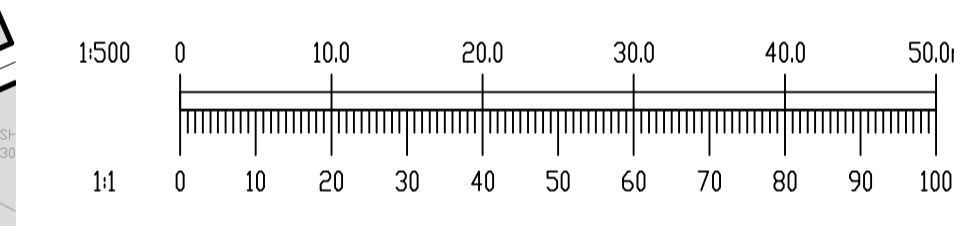
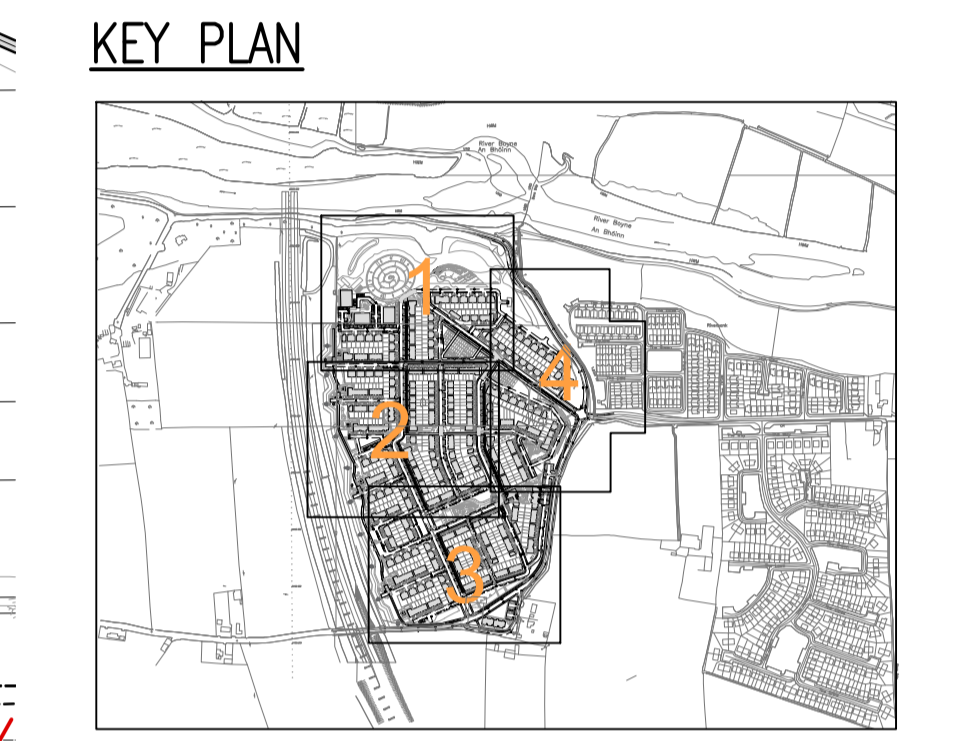

REV.	DATE	AMENDMENT	DRN	APPD

STATUS **FOR PLANNING ONLY
NOT FOR CONSTRUCTION**

Waterman Moylan
Engineering Consultants

BLOCK 5, EASTPOINT BUSINESS PARK, ALFIE BYRNE ROAD,
DUBLIN D03 H3F4 IRELAND. Tel: (01) 664 8900
Email: info@waterman-moylan.ie www.waterman-moylan.ie

CLIENT TRAILFORD LTD
ARCHITECT NDBA ARCHITECTS

PROJECT
**PROPOSED RESIDENTIAL DEVELOPMENT,
RATHMULLAN,
DROGHEDA**

TITLE
**PROPOSED ROAD LAYOUT, LEVELS
SHEET 2 OF 4**

DRAWN	DESIGNED	APPROVED	DATE
G.Byrne	BW	JG	AUG. '19
SCALE	JOB NO.	DRG. NO.	REVISION
1:500 @A1	18-014	P007	

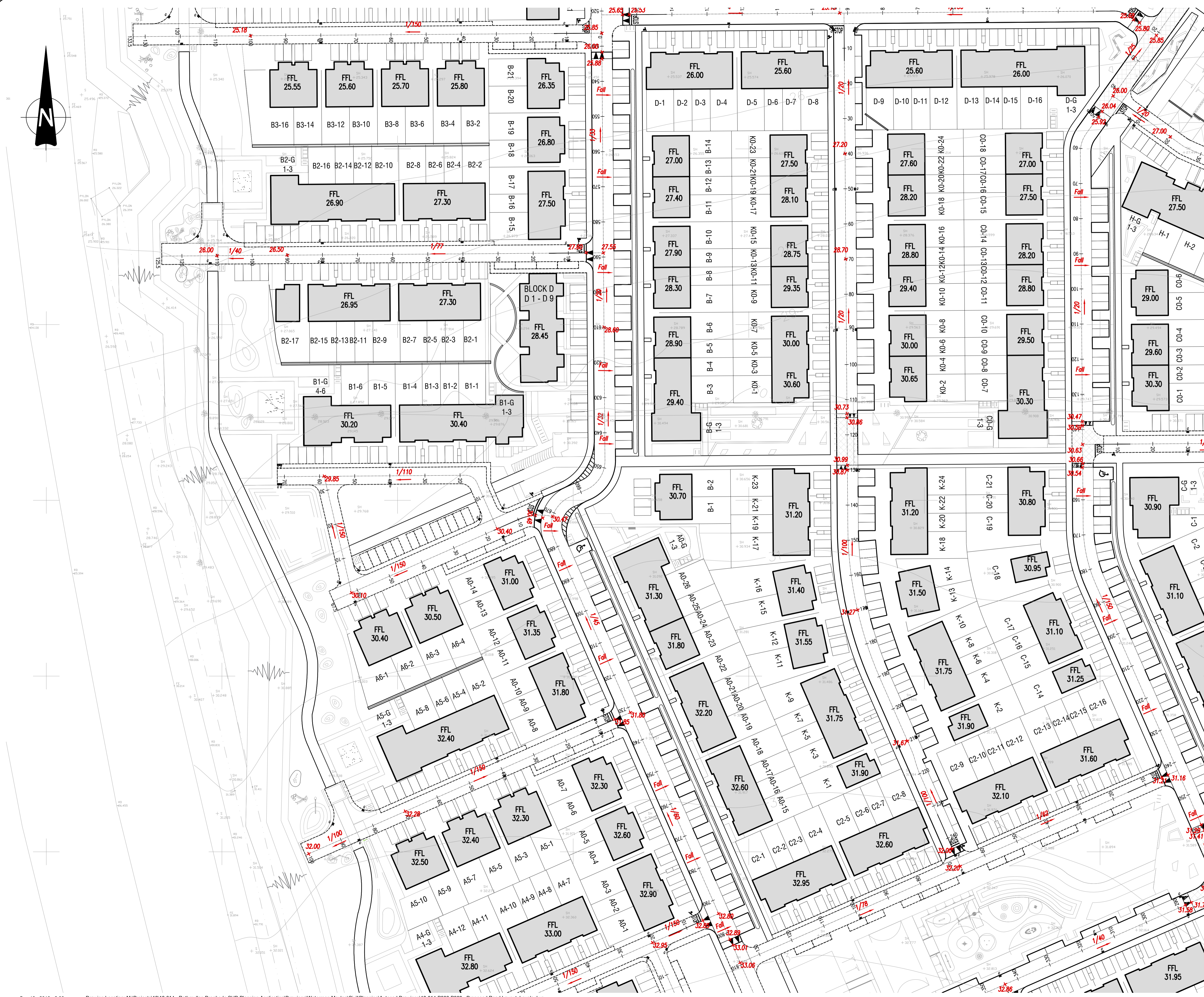

© 2017. This drawing is copyright. No part of this document may be reproduced or transmitted in any form or stored in any retrieval system of any nature without the written permission of the consulting engineer or copyright holder except as agreed for use on the project for which the document was originally issued.